



Installation

## Air distribution module

  
**AUSTROFLAMM**

[www.austroflamm.com](http://www.austroflamm.com)

06/02/2024

Version:

#### LEGAL NOTICES

Owner and publisher

AUSTROFLAMM GMBH

Austroflamm-Platz 1

A- 4631 Krenglbach

Tel: +43 (0) 7249 / 46 443

[www.austroflamm.com](http://www.austroflamm.com)

[info@austroflamm.com](mailto:info@austroflamm.com)

Edited by: Olivera Stojanovic

Illustrations: Konstruktion

Text: Technical department (Austroflamm)

#### Copyright

All Rights reserved. The contents of these instructions may be reproduced or distributed only with the consent of the publisher! Printing, spelling and typographical errors reserved.

The information in this document is subject to change without prior notice and should not be construed as a commitment by Austroflamm GmbH. Austroflamm GmbH assumes no responsibility for any errors that may appear in this document.

---

## Contents

1	Mo Duo - installing the air distribution module .....	4
2	Clou Duo - installing the air distribution module .....	13
3	Scotty Duo - installing the air distribution module.....	21
4	Ruby - installing the air distribution module .....	28
5	Software configuration .....	34

# 1 Mo Duo - installing the air distribution module

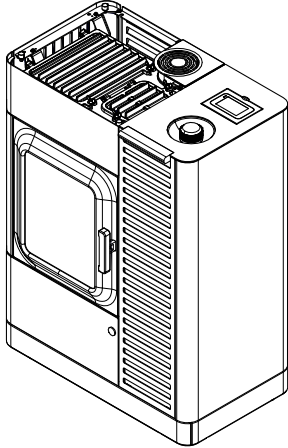
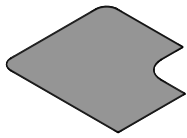


Fig. 1: Removing the cover

1) Remove cover.

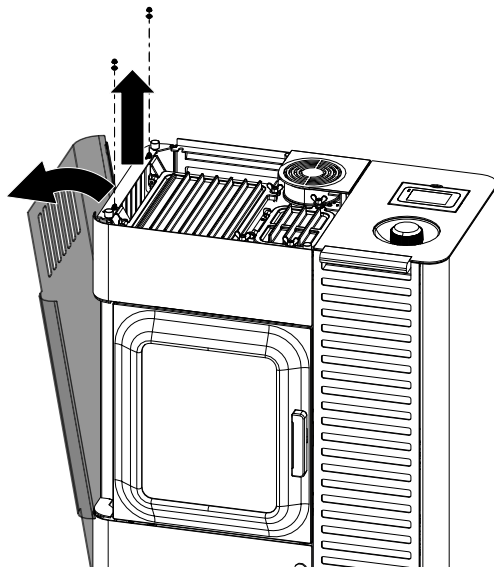


Fig. 2: Detaching the left-hand side cladding

- 2) From above, undo the two screws of the left-hand side cladding.
- 3) Pull the side cladding towards you at the top and un-hinge it at the bottom.

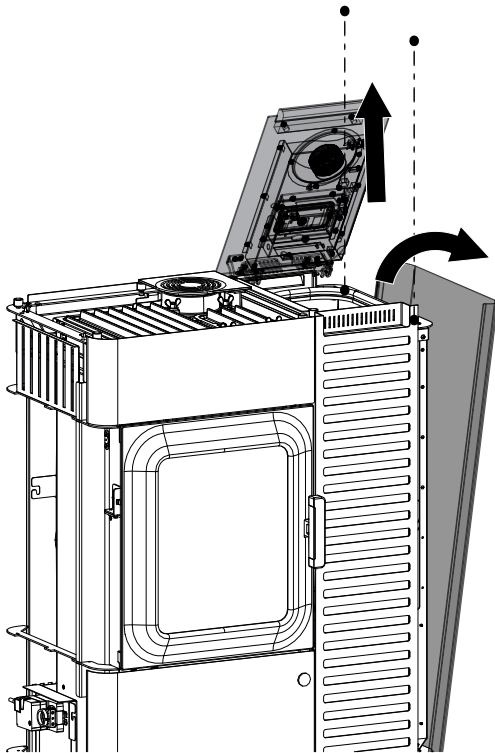


Fig. 3: Detaching the right-hand side cladding

- 4) Open hopper lid.
- 5) From above, undo the two screws of the right-hand side cladding.
- 6) Pull the side cladding towards you at the top and unhinge it at the bottom.

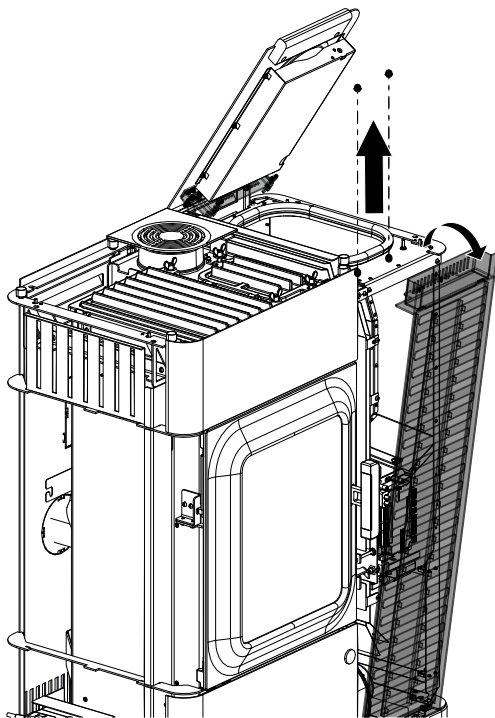


Fig. 4: Detaching the front side cladding

- 7) From above, undo the two screws of the front side cladding.
- 8) Pull the side cladding towards you at the top and unhinge it at the bottom.

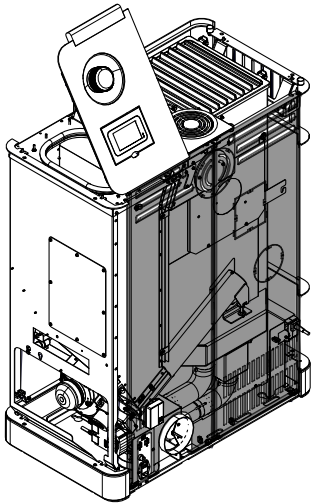


Fig. 5: Removing the rear panel

9) Remove rear panel.

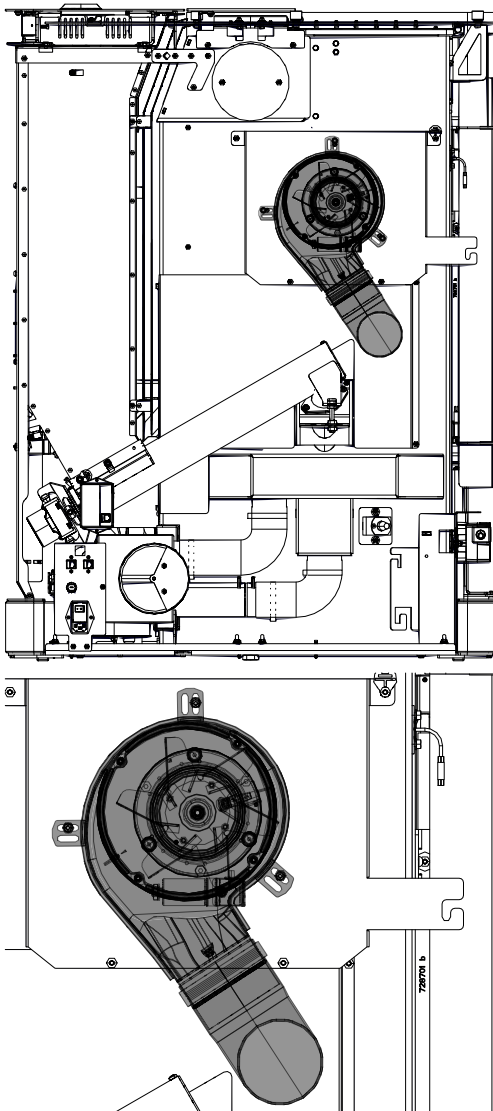


Fig. 6: Attaching the air module

10) Attach air distribution module to the stove and fasten it.

⇒ When doing so, follow the correct installation as shown below.



Fig. 7: Connecting the cables

- 11) Connect to each other the cable from the air distribution module and the cable which leads to the control unit.
- 12) Secure the upper part of the cable with a cable tie.

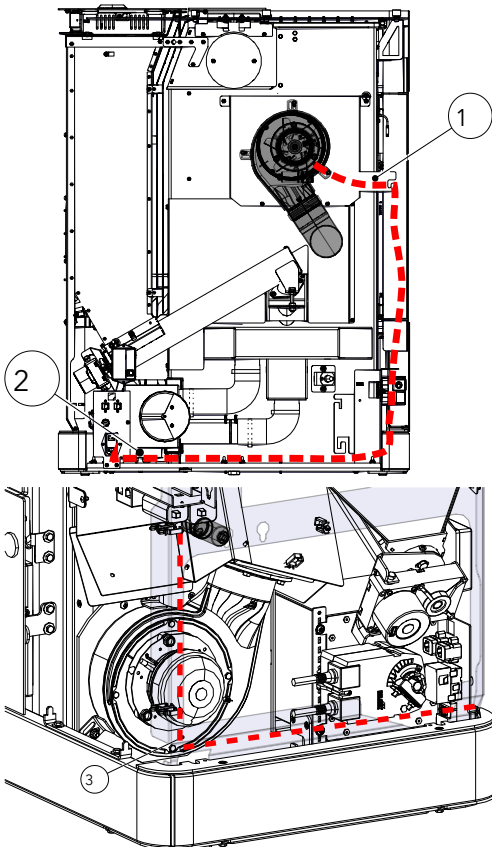
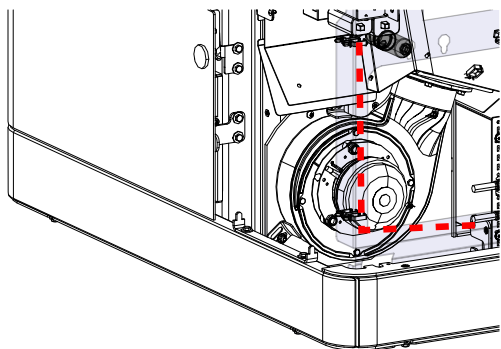


Fig. 8: Laying the cable

- 13) Lay the cable in the stove as shown and fix to points 1 + 2 + 3 with a cable tie.



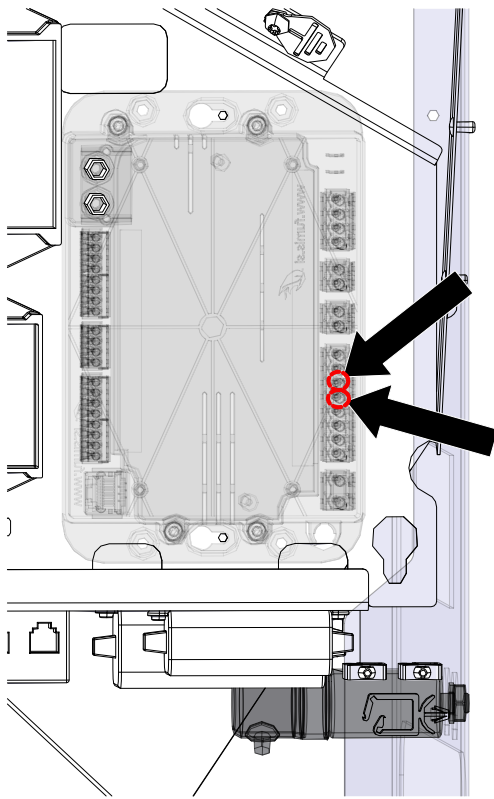
14) Connect to the condenser.

- ⇒ When doing so it is not important which cable is connected to which connection.



Fig. 9: Connecting the cable to the condenser





15) Clip air distribution cable on to the control unit.

- ⇒ There are two cables (grey and brown) to be plugged in. It does not matter which cable is connected to which connection.
- ⇒ Connection to position 5+6.

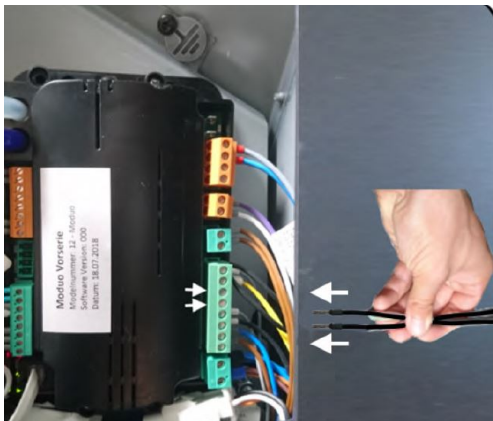
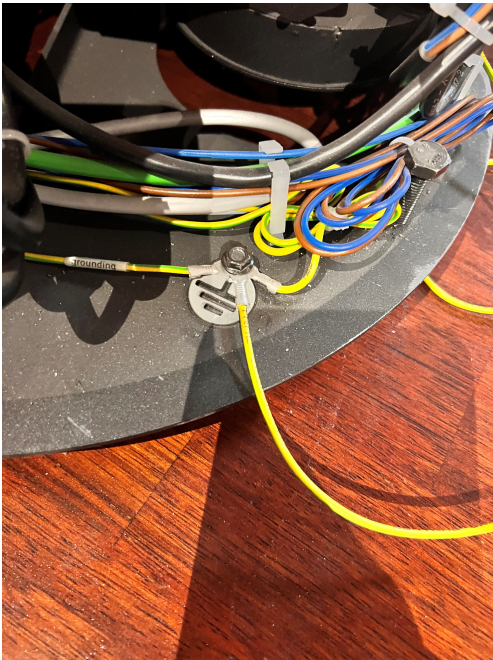
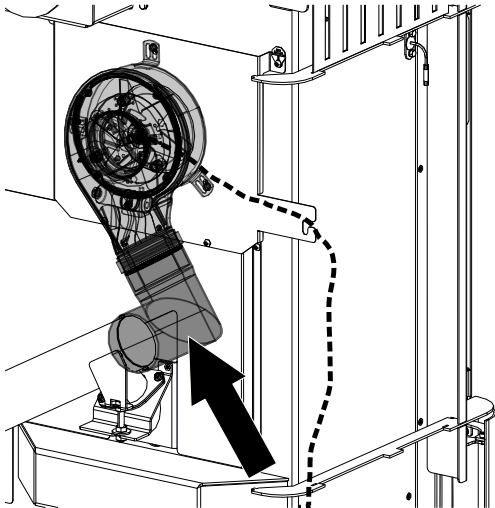


Fig. 10: Clipping on to the air distribution module



16) Connect central earth.

Fig. 11: Connecting the central earth



17) Place the L-pipe section on to the air distribution module.

Fig. 12: Placing the pipe

- 18) Using side cutters, remove perforated cut-outs on the rear panel.

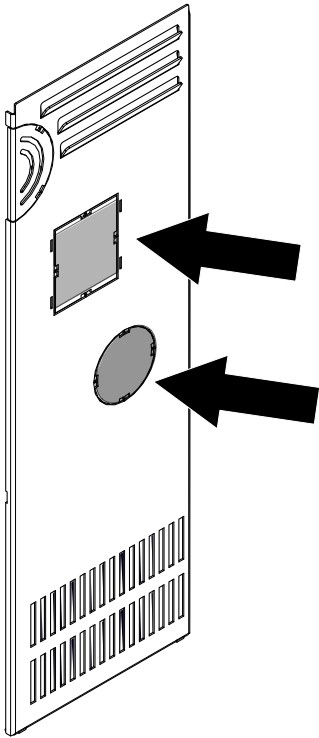


Fig. 13: removing the perforated cut-outs

- 19) First attach the rear panel, then attach all side cladding in reverse order and attach the cover.

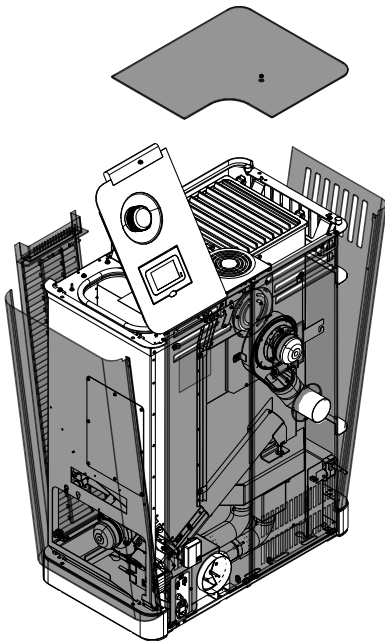
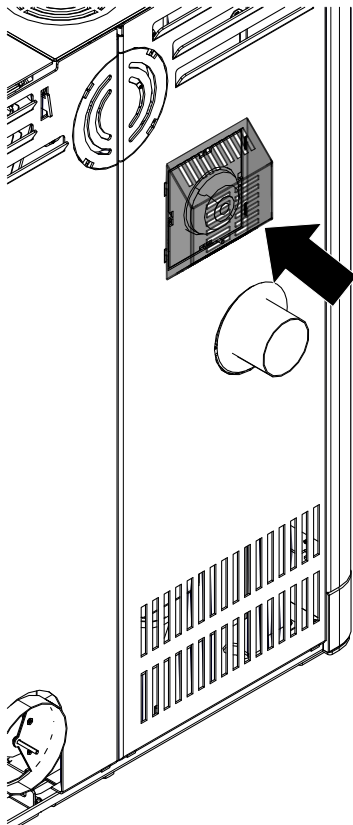


Fig. 14: Reattaching everything



20) Attach cover at the back on the rear panel.

Fig. 15: Attaching the cover on the rear panel

## 2 Clou Duo - installing the air distribution module

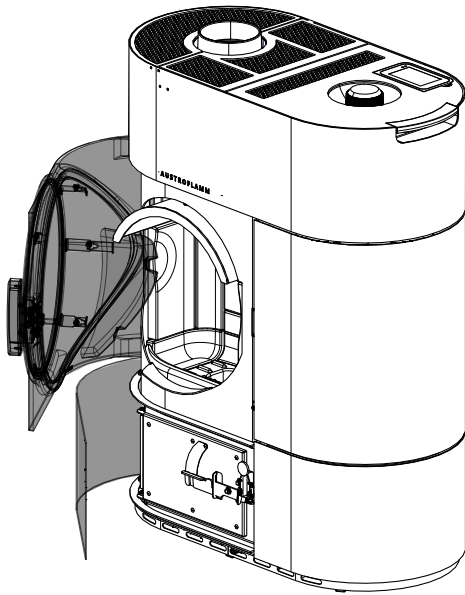


Fig. 16: Opening the doors

1) Open both doors.

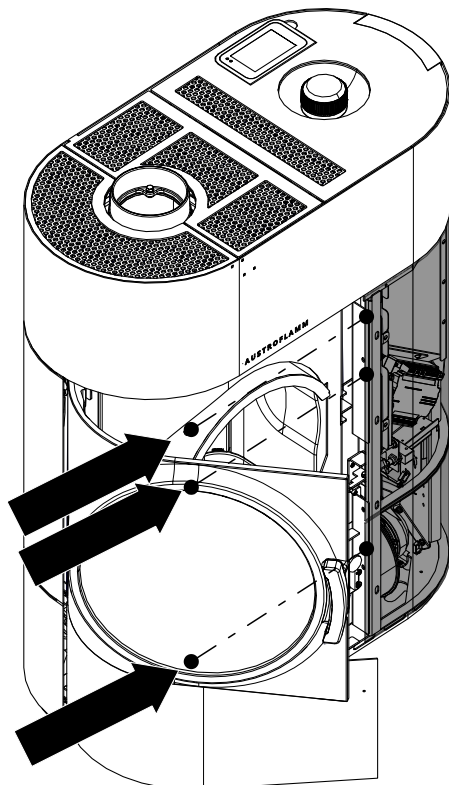
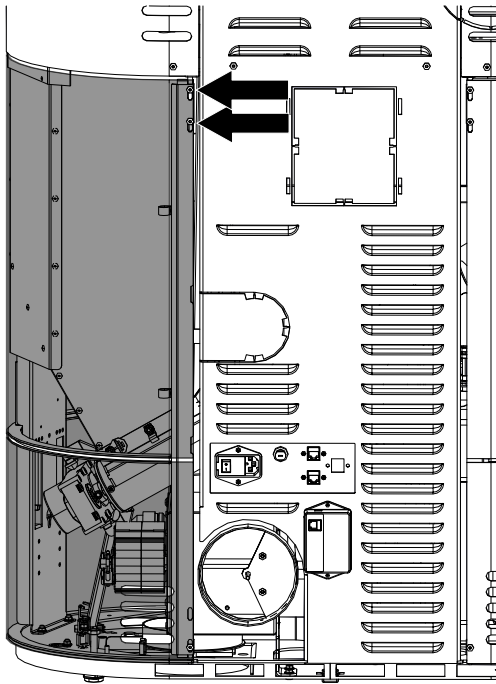


Fig. 17: Undoing the screws

2) Undo the screws of the right-hand side cladding from inside.



- 3) On the back at the top undo the screws of the side cladding and push the pin down.
- 4) Remove side cladding.

Fig. 18: Undoing the screws

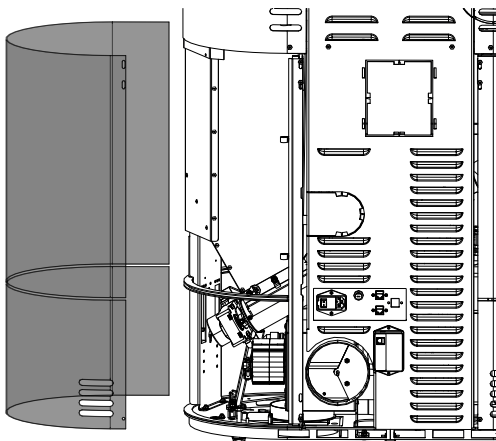


Fig. 19: Removing the side cladding

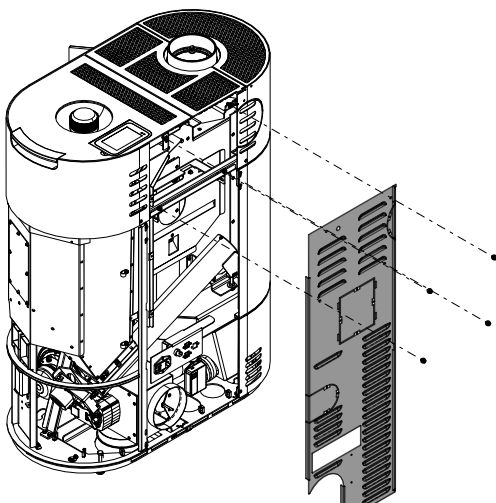


Fig. 20: Removing the rear panel

- 5) Undo the screws from the rear panel and remove the rear panel.

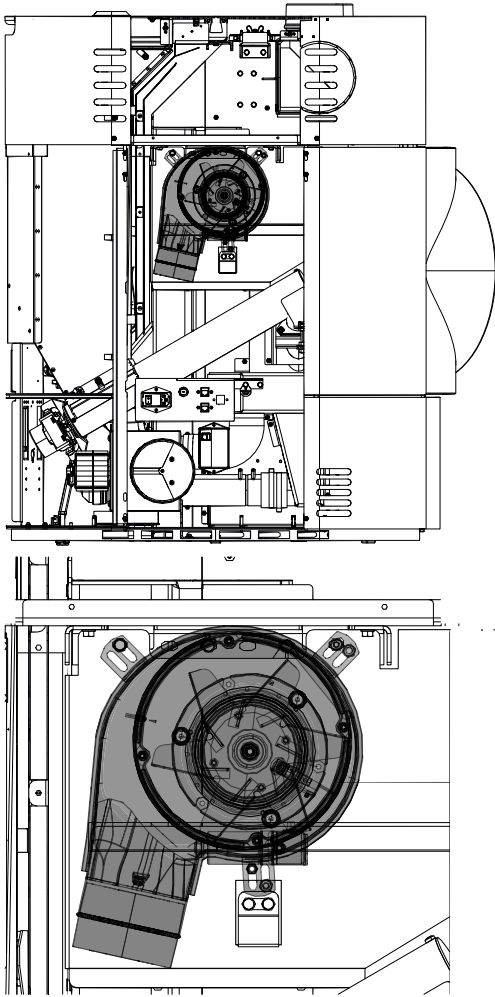


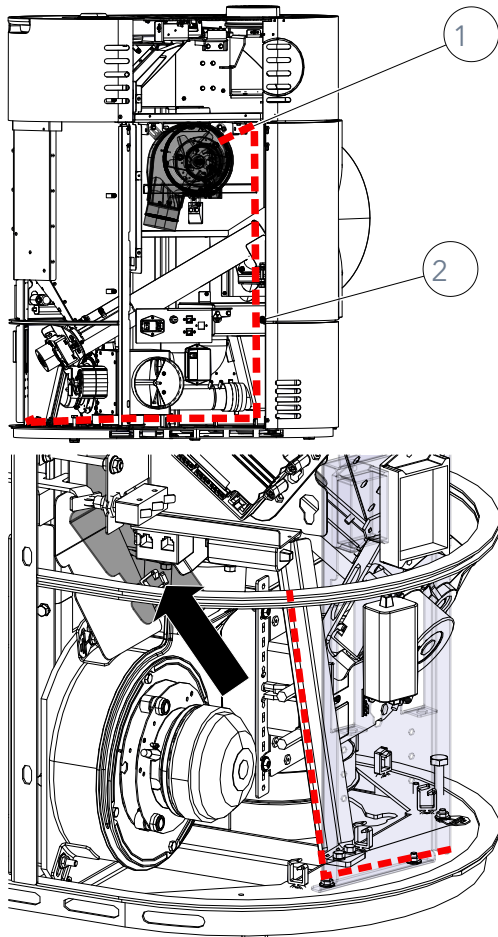
Fig. 21: Attaching the air module

- 6) Attach air distribution module to the stove and fasten it.
  - ⇒ When doing so, follow the correct installation as shown below.



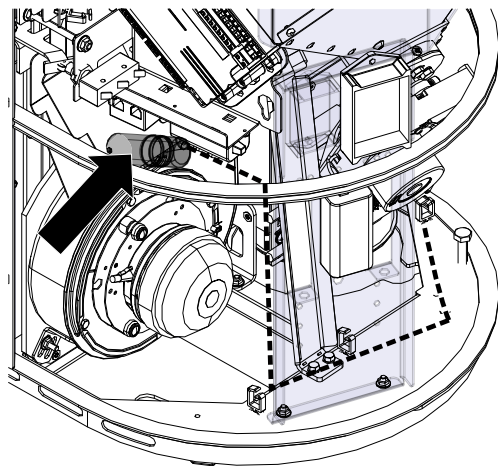
Fig. 22: Connecting the cables

- 7) Connect to one another the cable from the air distribution module and the cable which leads to the control unit.
- 8) Secure the upper part of the cable with a cable tie.



- 9) Lay the cable in the stove as shown and fix to points 1 + 2 with a cable tie.
- 10) As an option a cable clip may be attached at the point shown by the arrow. Remove this cable clip. There may only be a small hole there.
- 11) This hole must be rebored so that the condenser can be attached here.

Fig. 23: Laying the cable

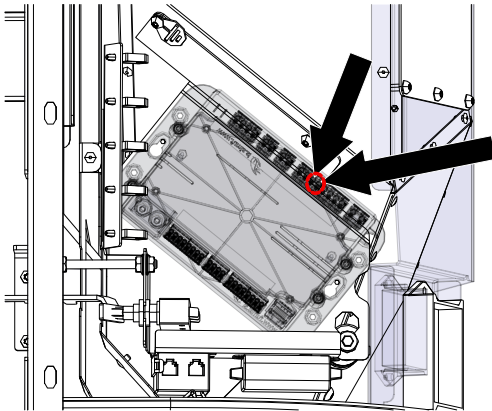


- 12) Attach the condenser at this point.
- 13) Connect cable to the condenser.
  - ⇒ When doing so it is not important which cable is connected to which connection.





Fig. 24: Connecting the cable to the condenser

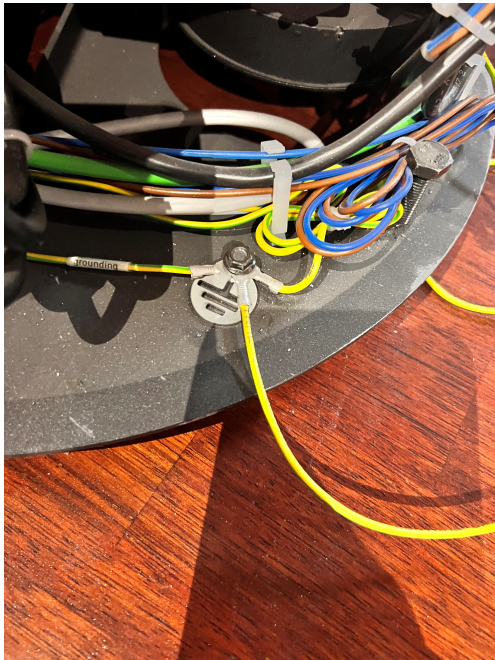


14) Clip air distribution cable on to the control unit.

- ⇒ There are two cables (grey and brown) to be plugged in. It does not matter which cable is connected to which connection.
- ⇒ Connection to position 5+6.

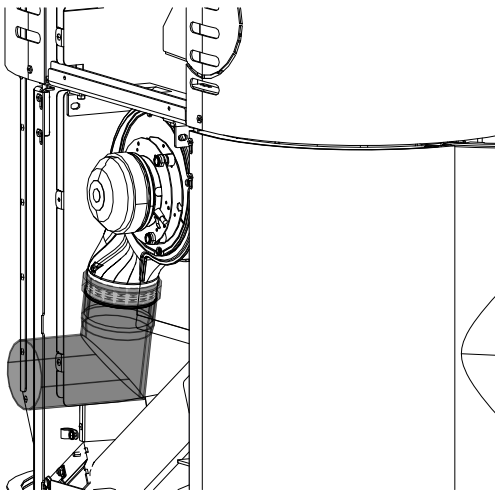


Fig. 25: Clipping on to the air distribution module



15) Connect central earth.

Fig. 26: Connecting the central earth



16) Place the L-pipe section on to the air distribution module.

Fig. 27: Placing the pipe

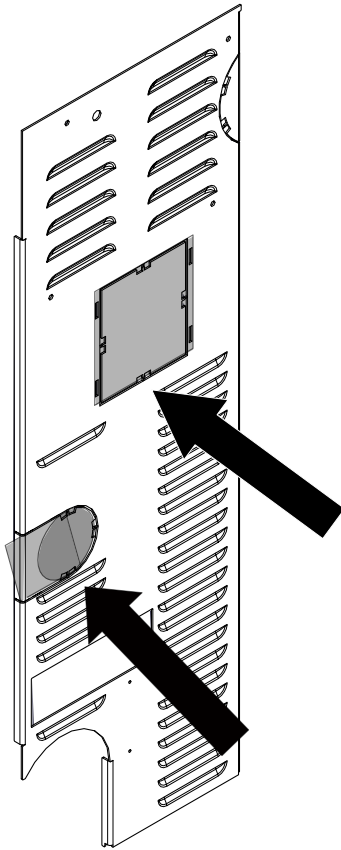


Fig. 28: removing the perforated cut-outs

- 17) Using side cutters, remove perforated cut-outs on the rear panel.

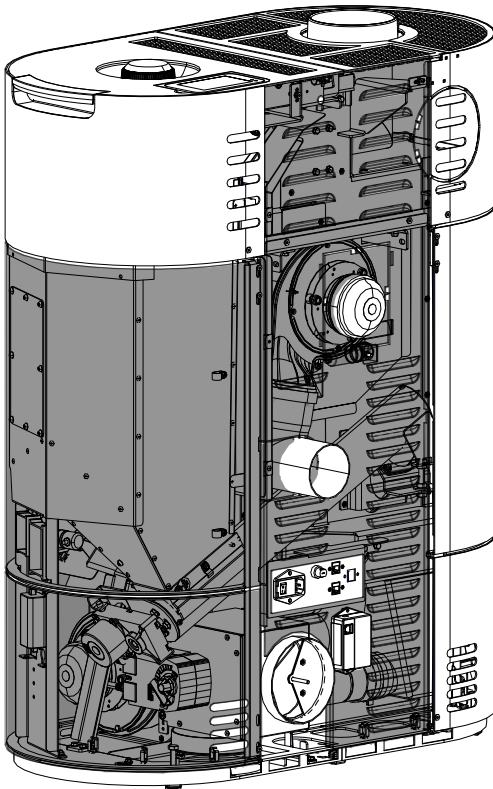
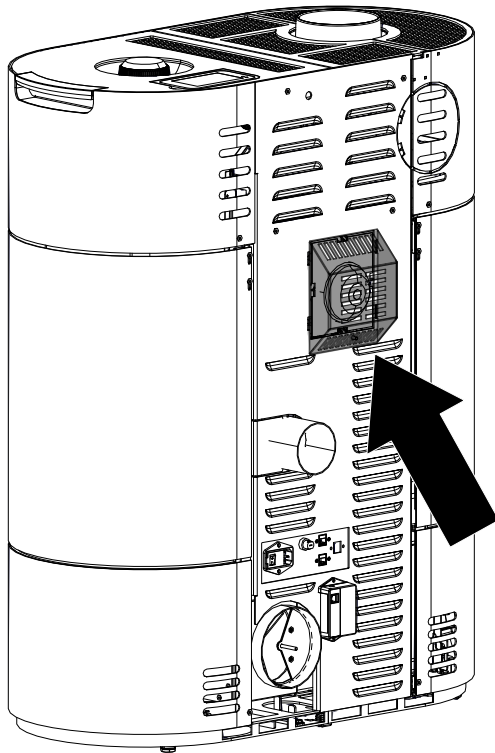


Fig. 29: Reattaching everything

- 18) First attach the rear panel and all right-hand side cladding in reverse order.



19) Attach cover at the back on the rear panel.

Fig. 30: Attaching the cover on the rear panel

### 3 Scotty Duo - installing the air distribution module

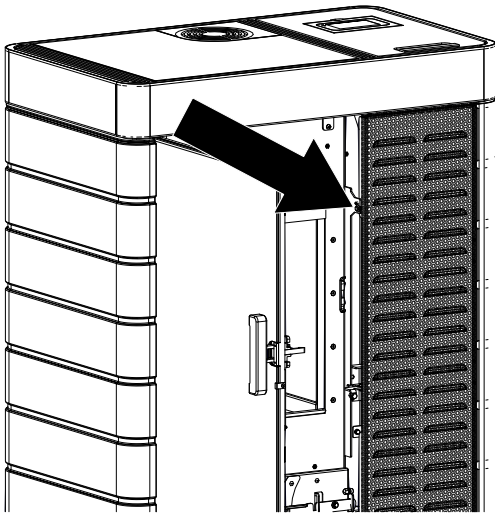


Fig. 31: Detaching the front side cladding

- 1) Open the door.
- 2) Undo screw from the front side cladding and remove the side cladding.

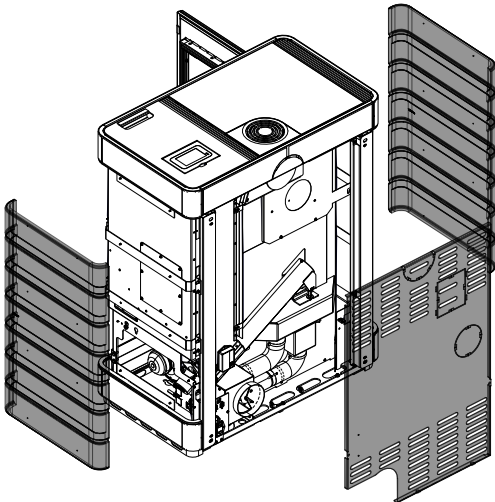
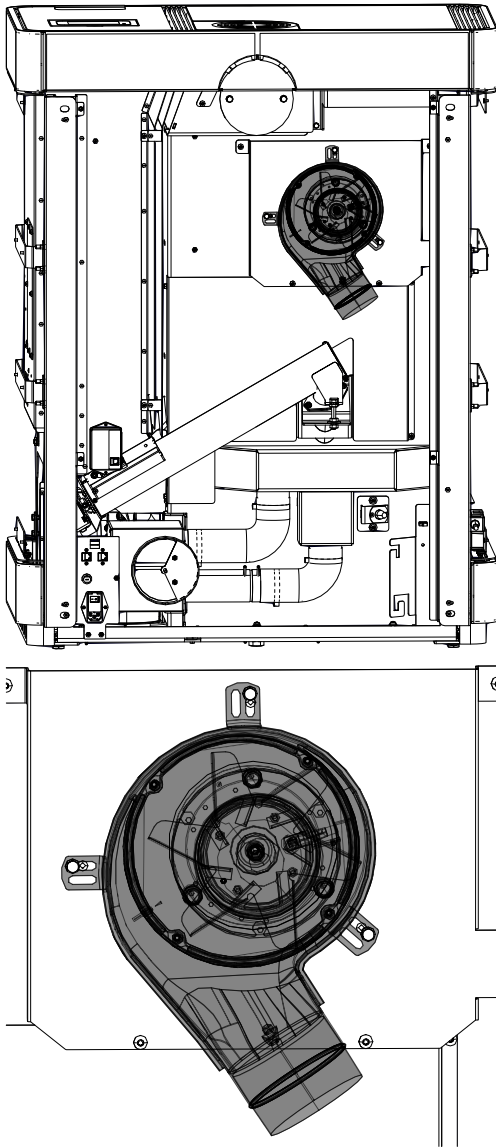


Fig. 32: Removing rear and side cladding

- 3) Remove rear, left-hand and right-hand side cladding.



- 4) Attach air distribution module to the stove and fasten it.
  - ⇒ When doing so, follow the correct installation as shown below.

Fig. 33: Attaching the air module



- 5) Connect to one another the cable from the air distribution module and the cable which leads to the control unit.
- 6) Secure the upper part of the cable with a cable tie.

Fig. 34: Connecting the cables

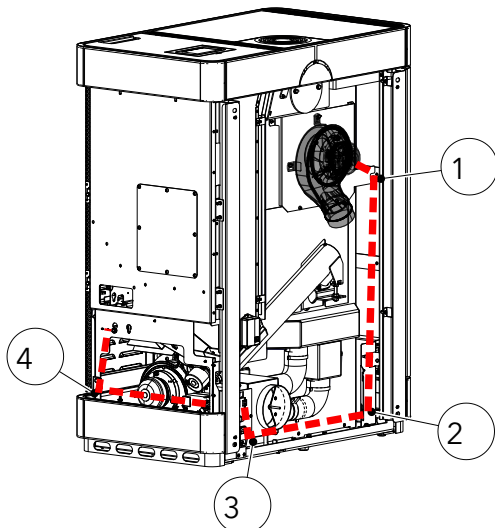
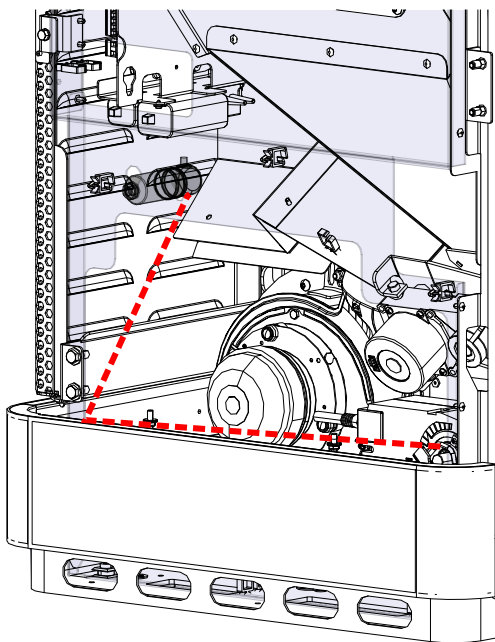


Fig. 35: Laying the cable

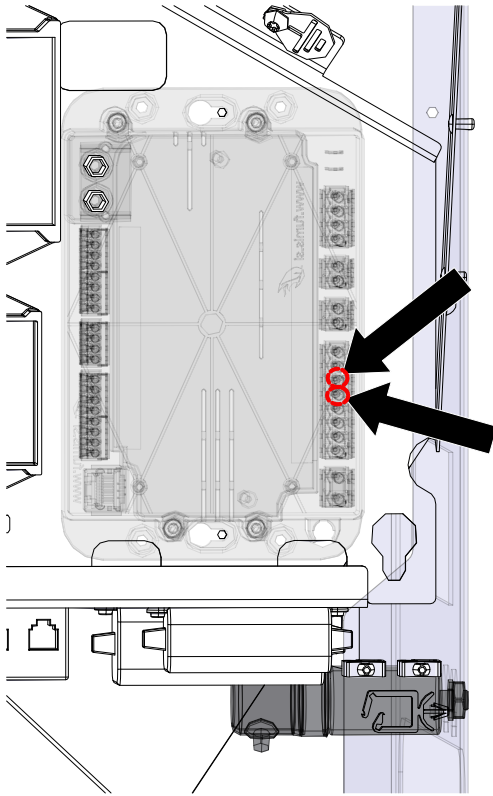
- 7) Lay the cable in the stove as shown and fix to points 1 + 2 + 3 + 4 with a cable tie.



- 8) Connect to the condenser.  
⇒ When doing so it is not important which cable is connected to which connection.



Fig. 36: Connecting the cable to the condenser



9) Clip air distribution cable on to the control unit.

- ⇒ There are two cables (grey and brown) to be plugged in. It does not matter which cable is connected to which connection.
- ⇒ Connection to position 5+6.

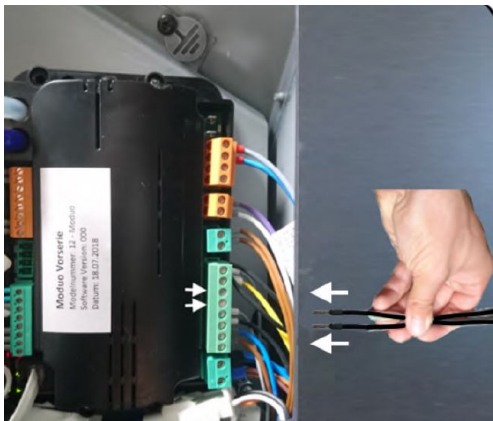
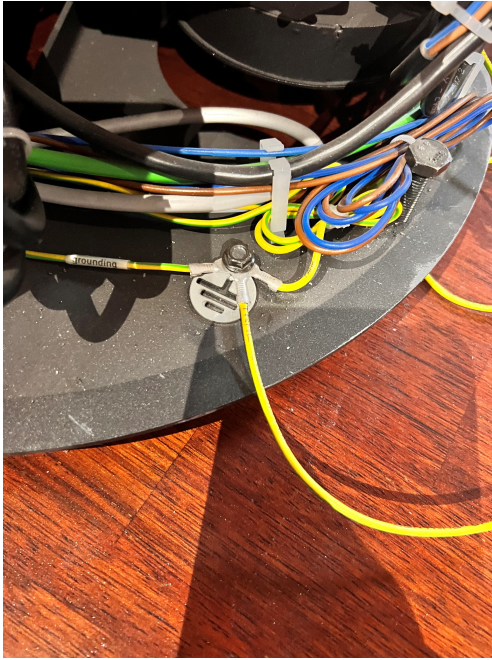


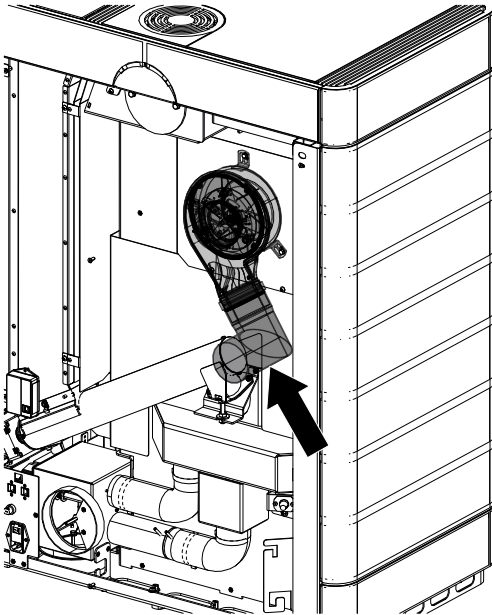
Fig. 37: Clipping on to the air distribution module





10) Connect central earth.

Fig. 38: Connecting the central earth



11) Place the L-pipe section on to the air distribution module.

Fig. 39: Placing the pipe

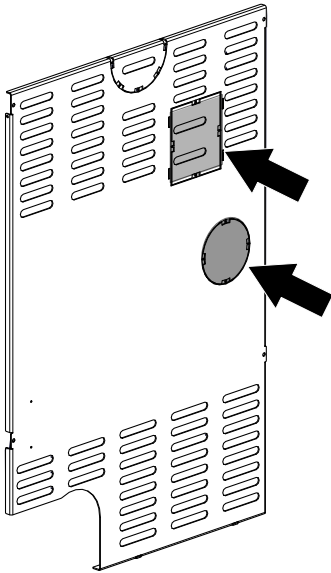


Fig. 40: removing the perforated cut-outs

- 12) Using side cutters, remove perforated cut-outs on the rear panel.

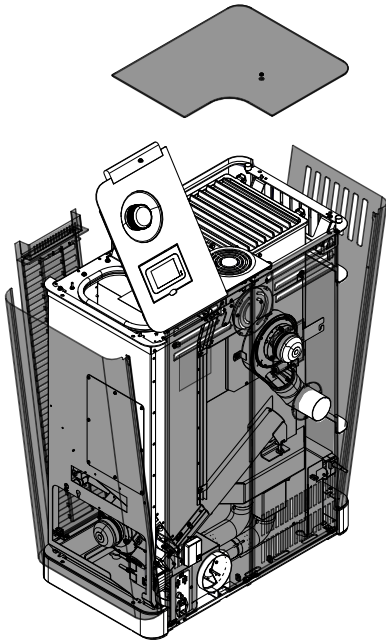
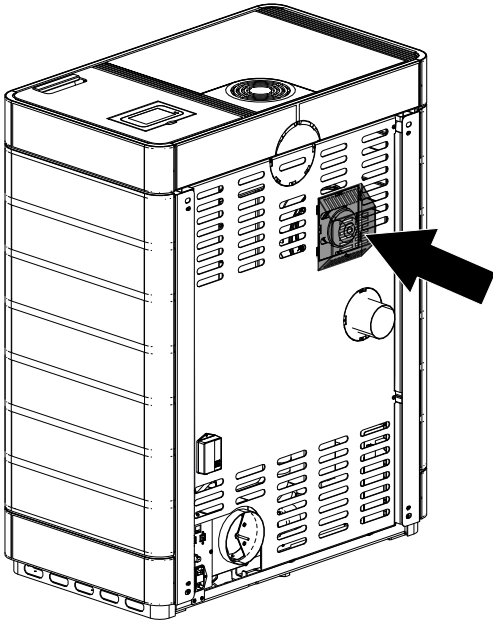


Fig. 41: Reattaching everything

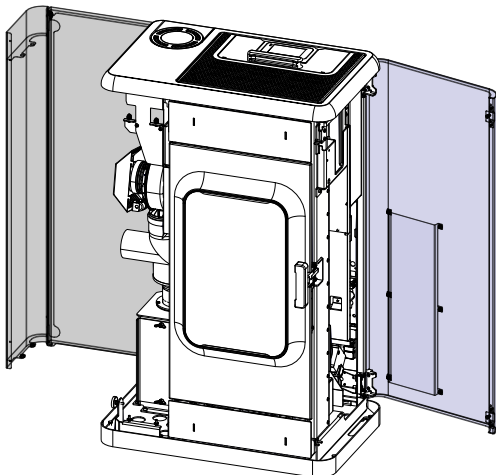
- 13) First attach the rear panel, then attach all side cladding in reverse order and attach the cover.

14) Attach cover at the back on the rear panel.



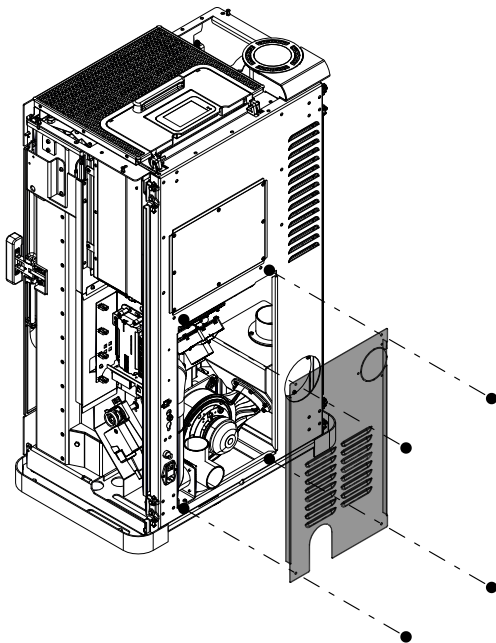
*Fig. 42:* Attaching the cover on the rear panel

## 4 Ruby - installing the air distribution module



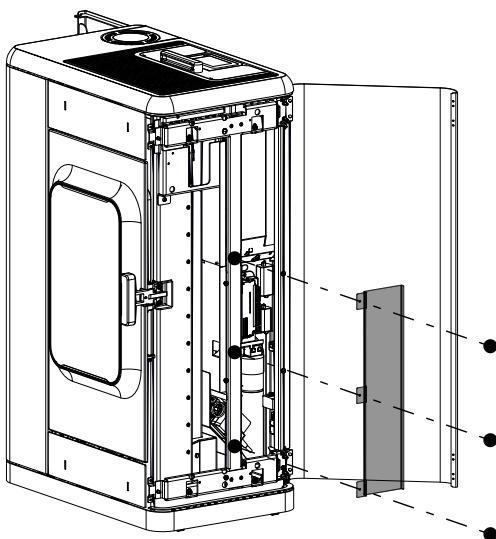
1) Open left- and right-hand side cladding.

Fig. 43: Opening the left- and right-hand side cladding



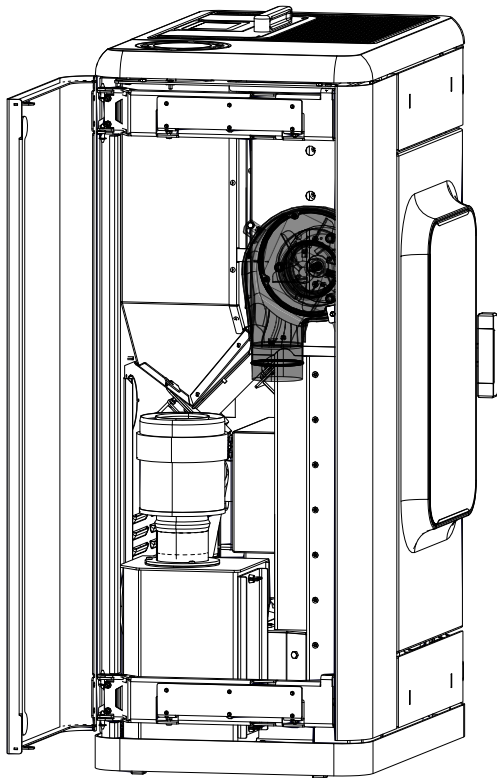
2) Remove the rear panel.

Fig. 44: Removing the rear panel



3) Detach cover.

Fig. 45: Detaching the cover



- 4) Attach air distribution module to the stove and fasten it.
  - ⇒ When doing so, follow the correct installation as shown below.

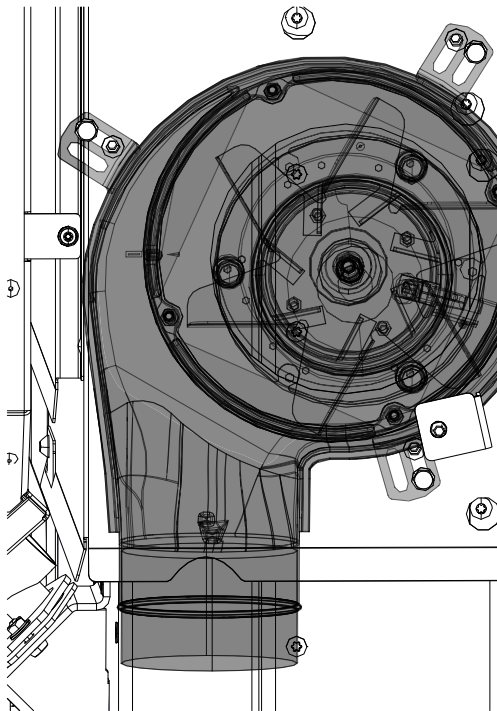


Fig. 46: Mounting the air distribution module



Fig. 47: Connecting the cables

- 5) Connect to each other the cable from the air distribution module and the cable which leads to the control unit.
- 6) Secure the upper part of the cable with a cable tie.

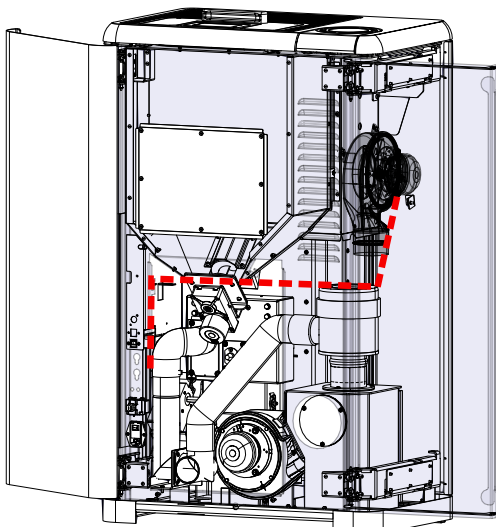
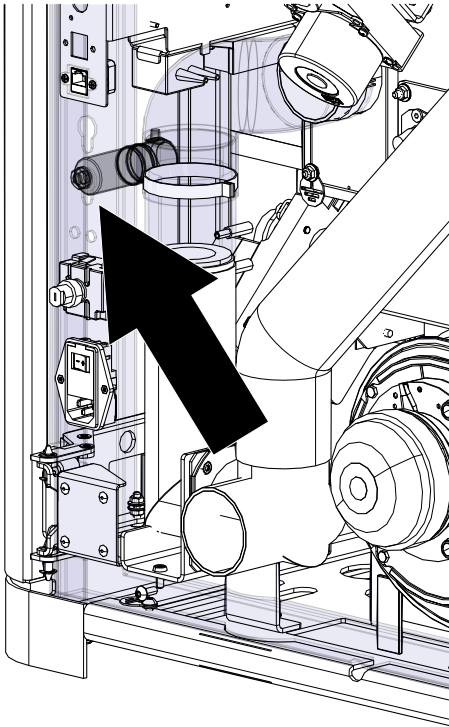


Fig. 48: Pulling the cable through

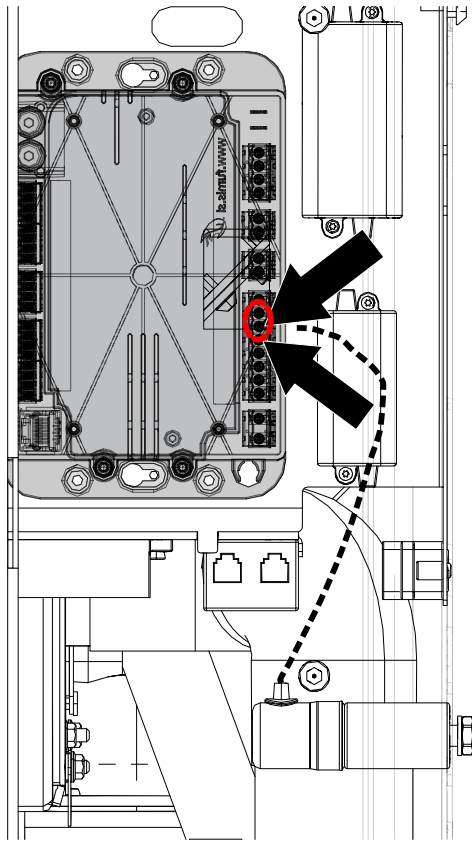
- 7) Lay the cable in the stove as shown and fix it with cable ties.



- 8) Connect cable to the condenser.
  - ⇒ When doing so it is not important which cable is connected to which connection.



Fig. 49: Capacitor



- 9) Clip air distribution cable on to the control unit.
- ⇒ There are two cables (grey and brown) to be connected. It does not matter which cable is connected to which connection.
  - ⇒ Connection to position 5+ 6.



Fig. 50: Clipping on to the air distribution module

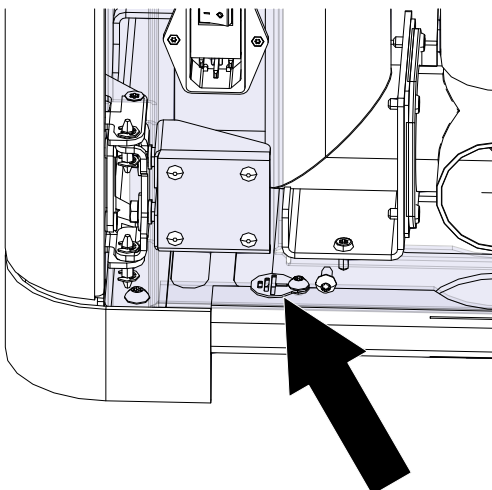


Fig. 51: Connecting the central earth

- 10) Connect central earth.



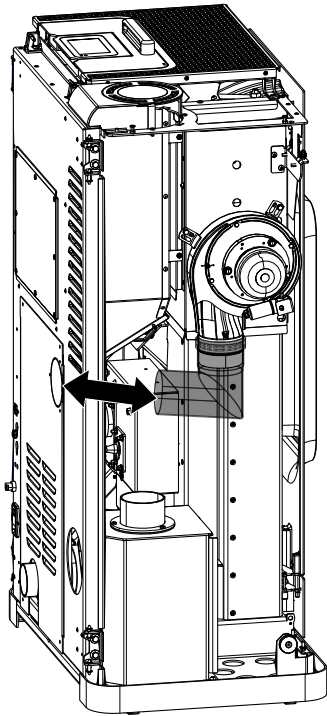


Fig. 52: connecting using the connecting pipe

- 11) Place the L-pipe section on to the air distribution module.

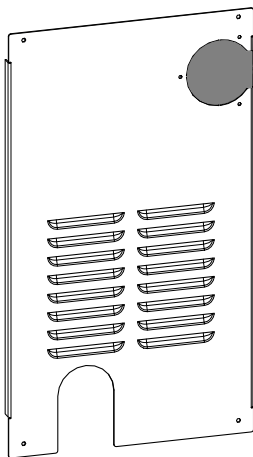


Fig. 53: removing the perforated cut-out

- 12) Using a saw, remove the perforated cut-out on the rear panel.

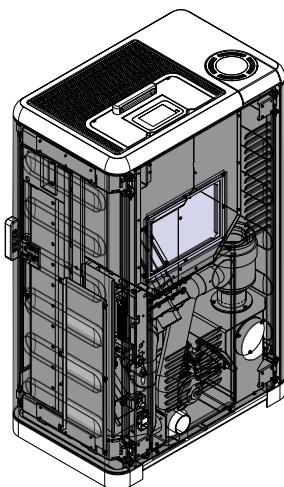
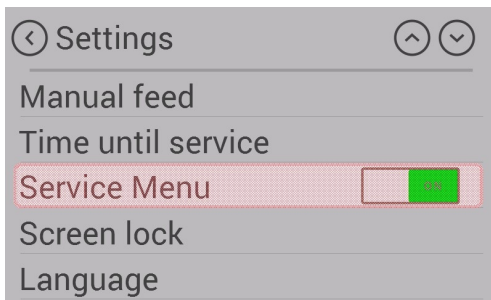


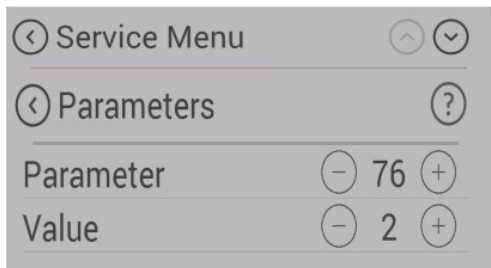
Fig. 54: Attaching rear panel and side cladding

- 13) Reattach rear panel and all side cladding.

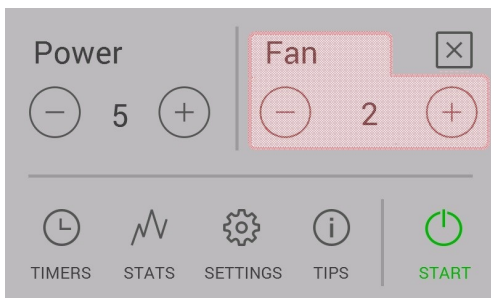
## 5 Software configuration



- 1) To enable the "Air Module" option, select the service menu in the settings.
- 2) Dealers or Austroflamm only: to get into the service menu, please enter the service CODE.



- 3) In the service menu, select "Parameters" and in Parameter no. "76" change the value from 1 to 2.



- 4) Now disconnect the stove from the power supply and start it up again.
- 5) After the stove has been restarted the fan speed can now be selected from the main menu. The fan will only start to turn at a firebox temperature of 200°C.



AUSTROFLAMM GMBH  
Austroflamm-Platz 1  
A- 4631 Krenglbach

Tel: +43 (0) 7249 / 46 443  
[www.austroflamm.com](http://www.austroflamm.com)  
[info@austroflamm.com](mailto:info@austroflamm.com)

